

FLUOR IGODA

Projects (Pty) Ltd



Local Company
Local Knowledge
Local Solutions
International Practices

OVERVIEW

Fluor Overview

Fluor is a global leader in the fields of engineering, procurement, construction, maintenance, and project management. Active across six continents, we work with our Clients to design, build, maintain, and operate many of the world's most complex, remote, and challenging facilities. Fluor is an integrated solutions provider with the technical expertise and financial strength to meet the most difficult assignments, from project conception through to operations and maintenance.

Igoda Overview

Igoda Projects is a South African engineering consulting firm providing electrical, instrumentation, process control and mechanical engineering services. Igoda Projects provides engineering solutions, project management services to industrial projects, private developers and government sector.

Fluor Igoda Overview

In 2006 Fluor and Igoda joined to form Fluor Igoda, a local South African entity specially focussed on offering a multifaceted solution to the local market. With local content and Broad-Based Black Economic Empowerment (B-BBEE) as core principals, Fluor Igoda offers a professional and proudly South African solution to our Clients' EPCm requirements.

Highly experienced in:

- Refinery Environment
- Bulk Fuel Storage Facilities and Infrastructure
- Environmental Compliance Projects
- Rail and Road Loading Gantries
- Marine Loading Arms

We Are An Integrated Solution Provider

SERVICE OFFERING

Fluor Igoda is part of Fluor's Energy and Chemical's Sustaining Capital Projects (SCP) business line, offering long term, site or home based EPCm solutions to industry.

A significant amount of depot, terminal and tank storage experience is housed in the Fluor Igoda office.

We are Subject Matter Experts (SME's) on items related to terminals and bulk fuel storage facilities.

Fluor Igoda has worked on over 40 terminals and depots around South Africa and is proud to have supported key Clients in their critical asset maintenance, upgrade, environmental compliance projects and capacity increase programs. With local based resources underpinned by the Fluor corporations' distributed execution platform, we competitively address Clients schedules and budgetary requirements.

Cape Town



Durban



FLUOR IGODA

Profile

- Established in 2006
- Full suite of engineering, procurement, project management and construction management services available
- In-plant engineering and modifications
- Small capital projects supports oil, gas and chemicals industry
- Long-term sustainable presence
- Commitment to local community

Capabilities

- 1,338 sqm office space
- Site-based engineering teams
- Up to 230 personnel
- Technical applications include:
 - 3D Modelling, MicroStation®,
 - SmartPlant 3D® Review and OptimEyes® Software
 - Hydraulic Modelling via PALS,
 - Fathom,
 - Process Modelling via PR02 and
 - Aspen Flarenet
 - Power system

PROJECT REFERENCE DETAILS

We have long standing relationships with many refineries - one of which is over 22 years .We have developed a solid execution platform to support the bulk fuels storage and logistics network. Some project references are as follows:



Project: Long Term EPCm Services Agreement
Location: Durban, South Africa
Scope: EPCm for Small Capital Projects & Plant Change Requests



Project: Master Products and Services Agreement
Location: Cape Town, South Africa
Scope: Small Capital Projects EPCm, Project Controls & Management

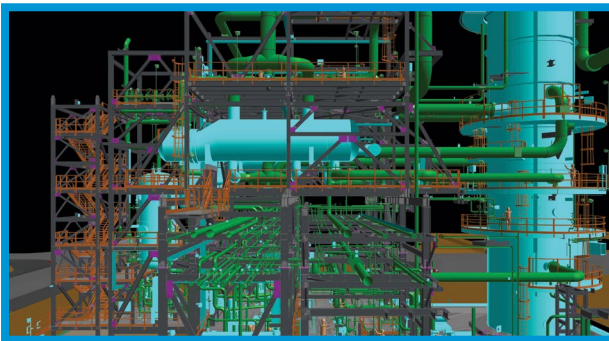

Project: Environmental Compliance Project
Location: Durban, South Africa
Scope: EPCm



Project: Long-Term Services Agreement
Location: Durban, South Africa
Scope: EPCm

CAPABILITIES AND STRENGTHS

Our network of Parent and Fluor Igoda offices include a presence in Johannesburg, Durban, Secunda & Cape Town. Fluor Igoda provides the full suite of engineering, procurement and construction management services, primarily to the petrochemical industry in South Africa, however via the larger Fluor network, our capability expands to address the fast moving consumer good (FMCG), pharmaceutical and railways industry.

Our service offering include:

- Full multi disciplinary Engineering
- Project Management
- Project Controls (Planning, Cost Estimating and Cost Control)
- Material and Contract Management
- Construction Management
- Health, Safety and Environment (HSE) Management
- Risk Engineering
- These services are supported by Quality Assurance, Project Administration and Project Business Services

Our unique position in the South African market place has supported our project delivery and Client satisfaction

ratings throughout various project stages. Our Clients benefit from the full in-house service offering and the flexibility we have to accommodate smaller, individual projects as well as more significant capital investments.

The fluctuating option to upscale or downscale whilst delivering consistent quality is highly valued.



Successfully executing projects in this challenging and dynamic market is something Fluor Igoda prides itself on, and we are excited by the potential opportunities the future holds.

SITE LISTINGS

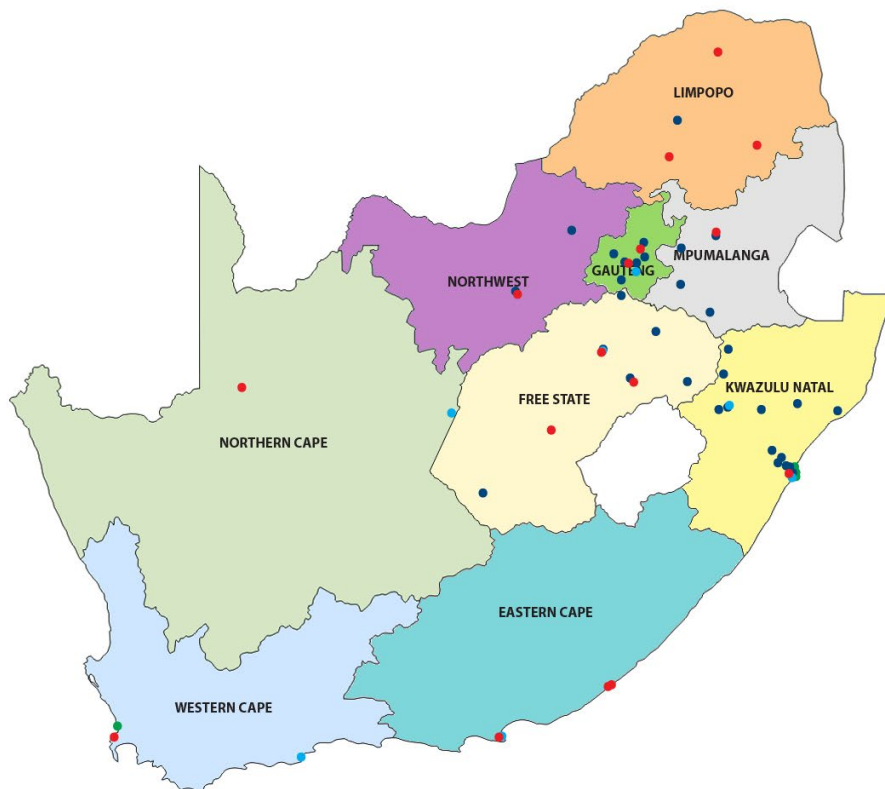

GAUTENG TPL Tarlton Alrode Witbank Langlaagte Pretoria West (Waltloo)	Mayerton Airport Wilge SHELL Alberton	ENGEN Johannesburg pipeline Terminal (Langlaagte) Pretoria Pipeline Terminal (Waltloo)
NORTHWEST TPL Rustenburg Klerksdorp		ENGEN Klerksdorp Pipeline Terminal
LIMPOPO SHELL Polokwane		ENGEN Hoedspruit Makhado Depot (Louis Trichardt) Mokopane Depot
KWAZULU NATAL TPL Durban Hillcrest Ladysmith Howick Empangeni Ingogo Quagga Newcastle	Fort Mistake Mooi River Duzi Mngeni Scheepersnek Pinetown SHELL Ladysmith Island View	SAPREF REFINERY VOPAK ISLAND VIEW ENGEN REFINERY VRU ENGEN REFINERY ENGEN Durban Terminal (Wentworth)
FREE STATE TPL Sasolburg Coalbrook Bethlehem Van Renen	Magdala Kroonstad Standerton SHELL Kroonstad	ENGEN Bethlehem Pipeline Terminal Bloemfontein Depot Kroonstad Pipeline Terminal
MPUMALANGA TPL Kendall Secunda	SHELL Rocky's Drift Witbank	ENGEN Witbank Joint Venture Terminal
NORTHERN CAPE SHELL Kimberly		ENGEN Upington Depot
WESTERN CAPE SHELL Mosselbay ENGEN REFINERY	ENGEN Cape Town Terminal (Montague Gardens)	
	EASTERN CAPE SHELL Port Elizabeth	ENGEN East London Ocean Terminal Port Elizabeth Harbour (Dom Pedro Jetty) East London Joint Harbour Facilities

CLIENT SOLUTIONS

Fluor Igoda is proud to offer a flexible and bespoke solution to our Clients' needs by offering a site-based or home office-based solution. Fluor Igoda currently has:

Site-Based Execution Teams providing:

- EPCm services on a multitude of sustaining capital and extraordinary maintenance projects
- Shutdown and Turnaround Construction management (sustaining capital projects and maintenance work)

Home Office Project Teams providing:

- EPCm services on multitude of sustaining capital projects. Project ranges from single figures to 60 per annum depending on Client requirements

- EPCm services on major capital projects
- Terminal modifications and upgrade projects
- Desktop studies on pipeline routing
- Process modeling

Fluor Igoda also offers offshore, or distributed execution solutions. Engineering is executed in standardised Fluor offices, the benefits of which are both schedule and commercially focused. These offices are located in Spain, Poland, India and the Philippines. These benefits are underpinned with the Fluor quality our Clients expect.

WE ARE HSE EXPERTS

Safety is a core value at Fluor Igoda. Every day we help Clients safeguard the environment, conserve energy, protect lives and strengthen the economies and social structures of communities.



ZERO IncidentsSM

Fluor Igoda Projects (Pty) Ltd
 Glass House Office Park
 Building 1
 309 Umhlanga Rocks Drive
 La Lucia Ridge, Durban, South Africa
 Tel: +27 31 581 4000
 Fax: +27 31 581 4050

Fluor Igoda Projects (Pty) Ltd
 Metropolitan Office Park
 Building E, Blouelie Street
 Platteklouf, Cape Town
 Tel: +27 21 202 4906

© 2015 Fluor Igoda. All rights reserved.
 FLUOR and OptimEyes are registered service marks of Fluor Corporation.
 MicroStation is a registered trademark of Bentley Systems, Inc.
 SmartPlant 3D is a registered trademark of Intergraph Corporation.